

Studio 5

Arriving

Understanding the flexibility of our guests and their differing arrival times we have installed a key security system. Simply approach the property from the decking. Pull down the master lock casing and enter **5555**. From this stage flick the black switch downward to open. **Check-in from 4pm**. See illustration below.



Departing

We require a **10am checkout** on day on departure for cleaning and turnaround. Please leave the key in Master lock container.

WiFi

Free and unlimited. Simply search on your devices for **PlusnetWireless5135D9** and enter Password **08FEE28068**

Your router setup details



Wireless Network

Name (SSID): PlusnetWireless5135D9
Password (Key): 08FEE28068

Router Access

Address: <http://192.168.1.254>
User: admin
Password: CP1337VFQJQ

Please note: all details are case sensitive



Smart TV

Ensure all the devices are turned on at the main wall in cupboard. Sky boxes tend to take 2-3mins to fully start-up. Simply turn on the TV using the Samsung remote. Press source until you reach HDMI to control the Sky or DVD. Please note that only basic channels are available with the Sky package. Approx. 240 digital channels.

Being a smart TV you can login to Netflix if you have an account, use catch-up services and the web.

Ceiling Speakers

My favourite part! You can set the TV or any Bluetooth device such as iPhone, iPad etc to play through the ceiling speakers. Controlling surround sound from the comfort of the couch. Turn Yamaha Amplifier as shown below:

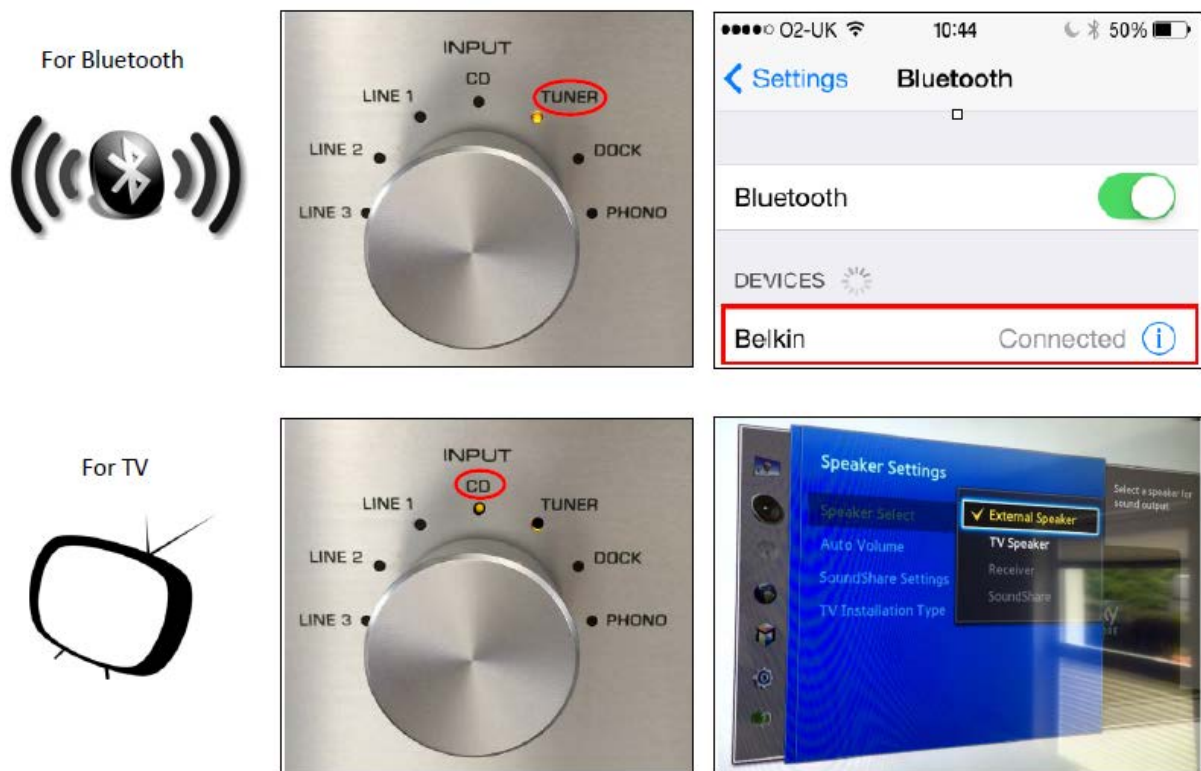

Contact

If you have any further queries, please don't hesitate to contact. Billy and Robina Nicolson look after the property and are available on Telephone: +441478612781 or Email: studio5skye@gmail.com

Location

Studio 5 is located at 5 Martin Crescent, Portree, Isle of Skye, IV51 9DW. Opposite to Portree fire station.

The property boasts some spectacular unspoilt sea views being sited on the corner of the Crescent. Click here to load Google maps location [Studio5](#)